

Emergency vehicle pre-emption unit

Sta 25+75-38' lt	Phase selector	2 ea
Sta 25+88-35' lt	Vehicle detector - mast arm mtd @ 21 Ft	1 ea
Sta 25+99-51' rt	Vehicle detector - mast arm mtd @ 15.5 Ft	1 ea
Sta 26+51-53' lt	Vehicle detector - mast arm mtd @ 21.5 Ft	1 ea
Sta 26+73-30.5' rt	Vehicle detector - mast arm mtd @ 17 Ft	1 ea
Various locations	12-2 conductor cable	654 LF
Various locations	Detector cable	654 LF

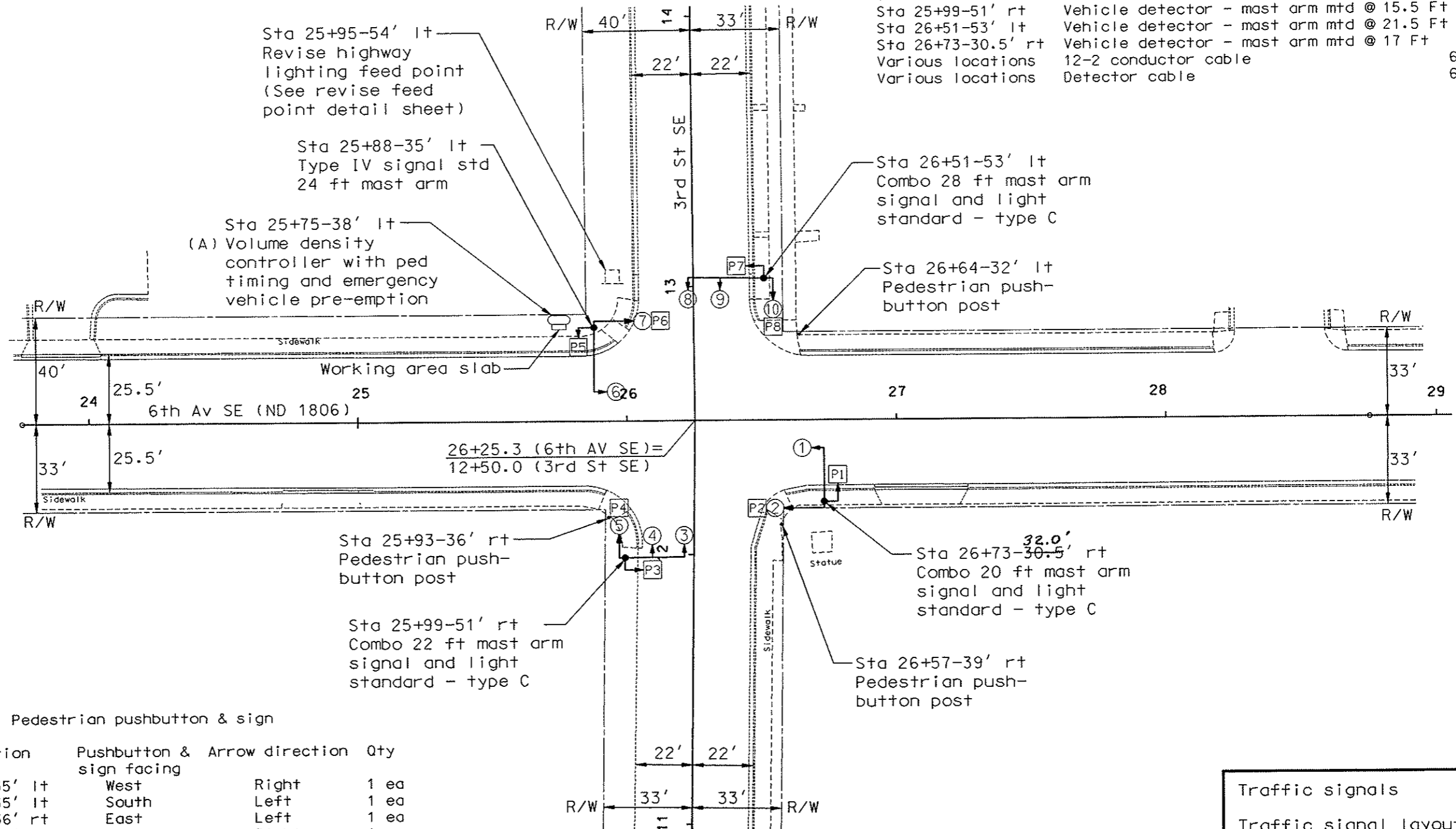

Pedestrian pushbutton & sign

Station	Pushbutton & sign facing	Arrow direction	Qty
25+88-35' lt	West	Right	1 ea
25+88-35' lt	South	Left	1 ea
25+93-36' rt	East	Left	1 ea
25+93-36' rt	South	Right	1 ea
26+57-39' rt	East	Right	1 ea
26+57-39' rt	North	Left	1 ea
26+64-32' lt	West	Left	1 ea
26+64-32' lt	North	Right	1 ea

(A) Controller door shall face west with hinges on north side.

Traffic signals  
 Traffic signal layout  
 6th Av SE (ND 1806) &  
 3rd St SE  
 Mandan, ND

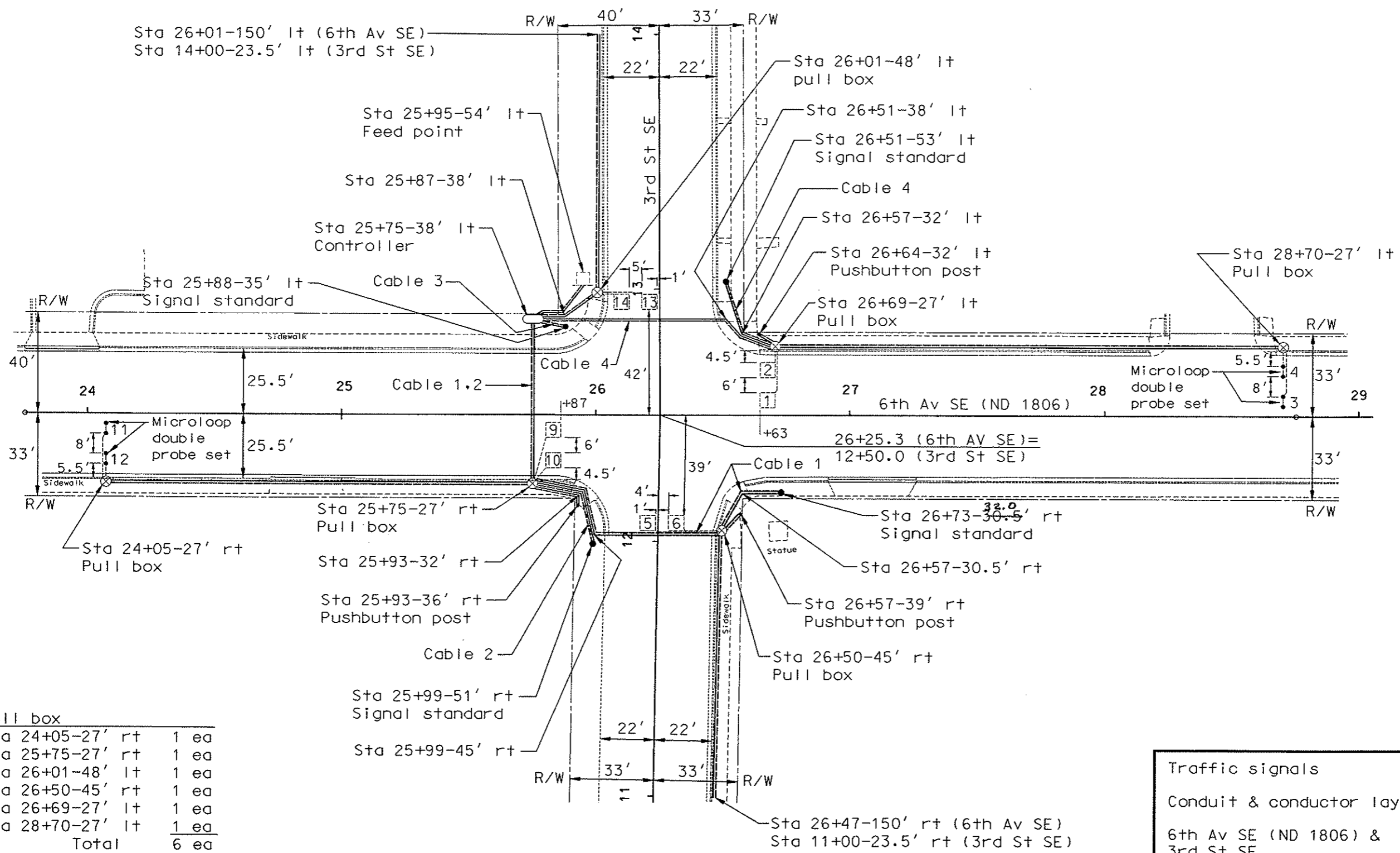
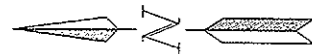

Pull box	
Sta 24+05-27' rt	1 ea
Sta 25+75-27' rt	1 ea
Sta 26+01-48' lt	1 ea
Sta 26+50-45' rt	1 ea
Sta 26+69-27' lt	1 ea
Sta 28+70-27' lt	1 ea
<b>Total</b>	<b>6 ea</b>

Traffic signals  
 Conduit & conductor layout  
 6th Av SE (ND 1806) &  
 3rd St SE  
 Mandan, ND