

CONSTRUCTION SIGN AND BARRICADE LOCATION DETAILS

FORM NO.	STATE	FED. A.C.P.R.C. NO.	SHEET NO.
8	N.D.	M-1-988(02)	60A

D-754-13-A

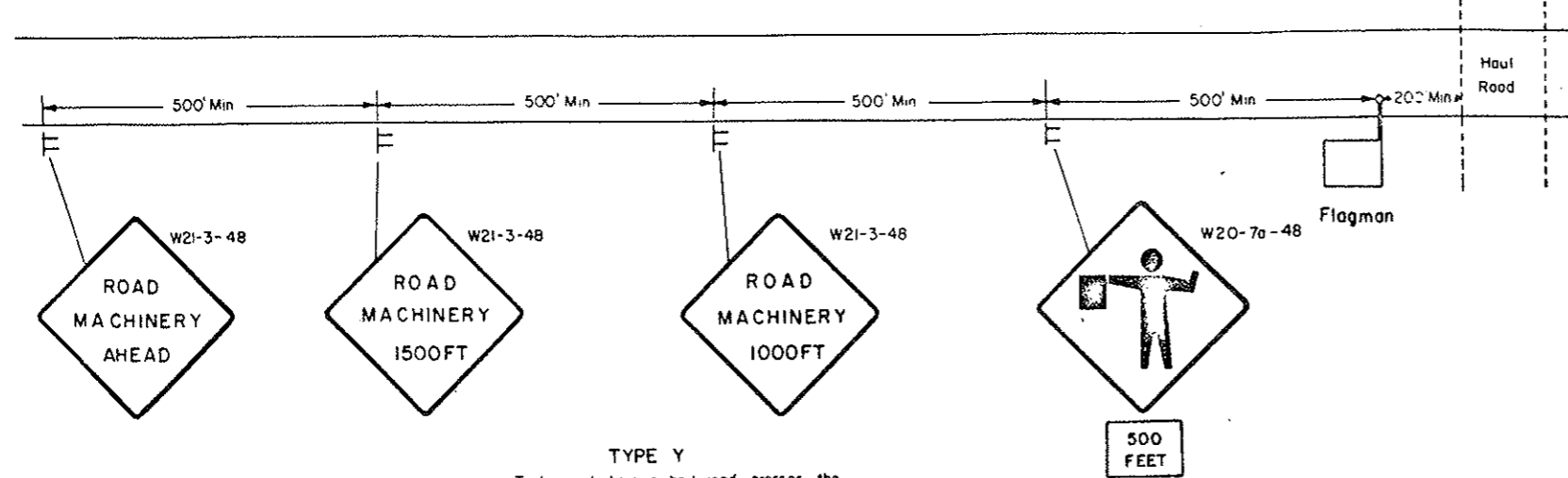

TYPE Y
To be used where a haul road crosses the highway outside a major work area.

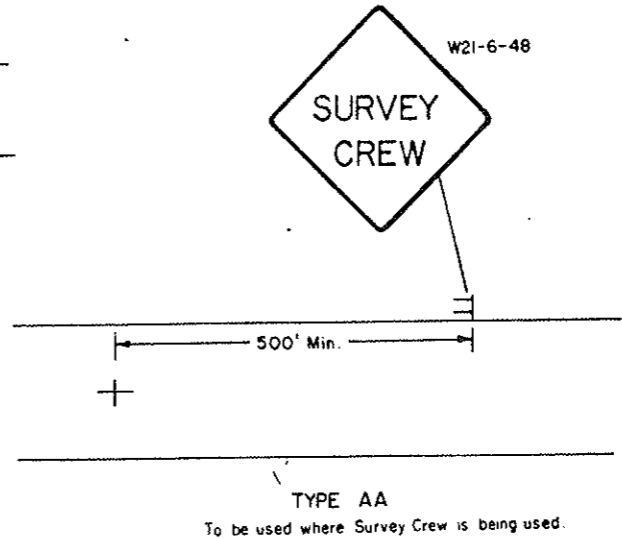

TYPE AA
To be used where Survey Crew is being used.

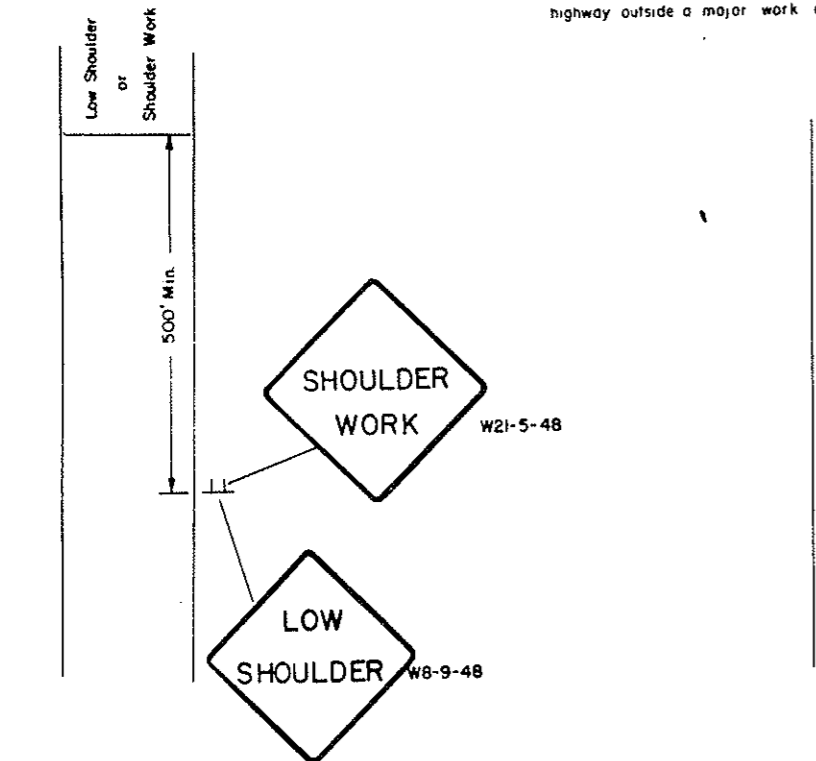

TYPE BB
To be used with in a major work area, where the sign conditions exist.

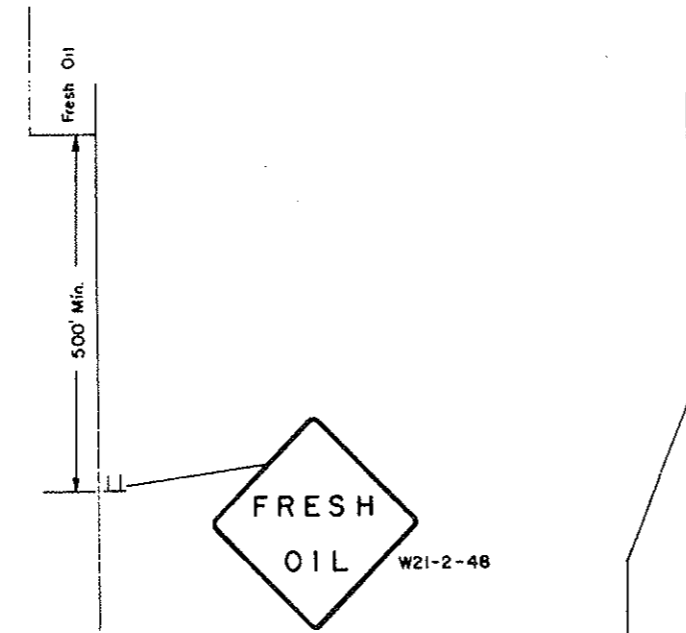

TYPE CC
To be used where the signed conditions exists

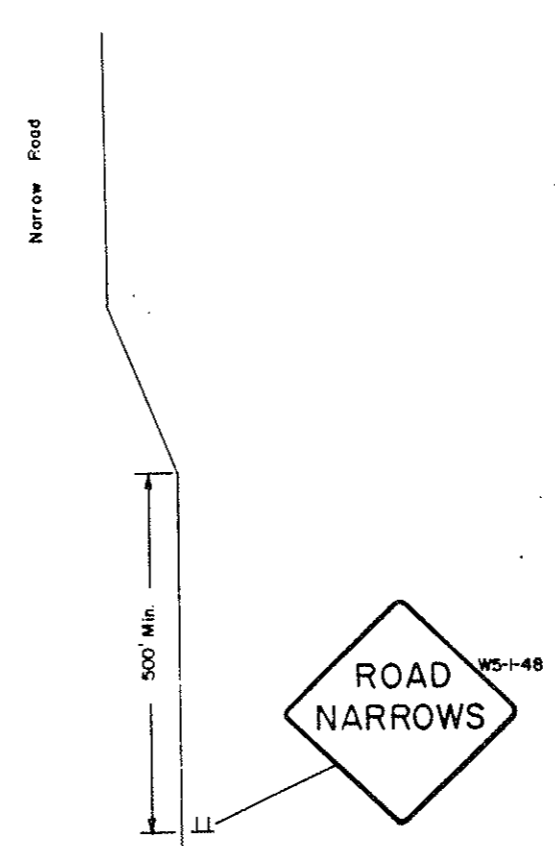

TYPE DD
To be used where the signed condition exists

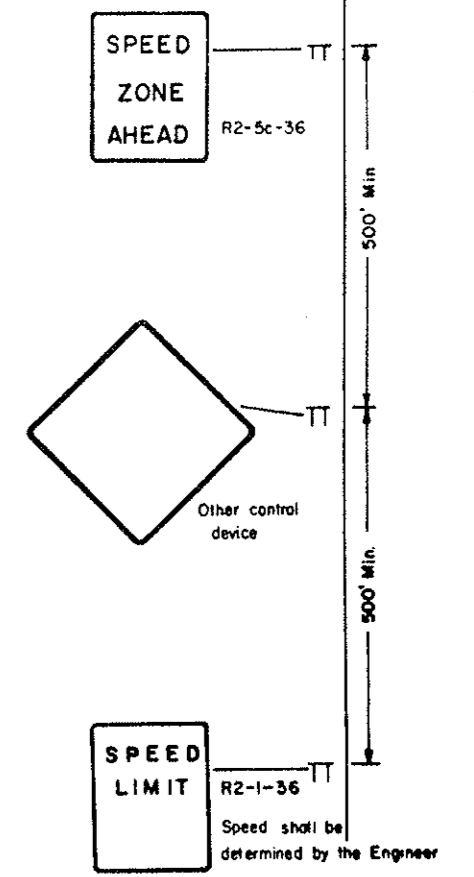

TYPE Z
To be used where speed zone is needed.

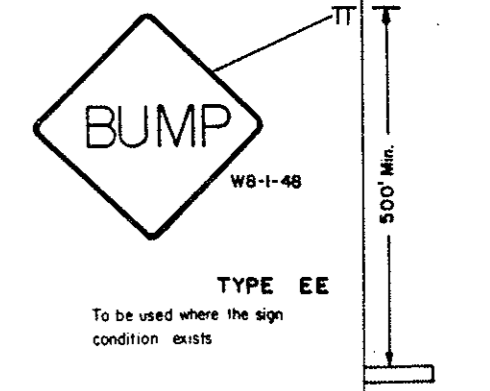

TYPE EE
To be used where the sign condition exists

3 - 9 - 79		NORTH DAKOTA STATE HIGHWAY DEPARTMENT
DATE	REVISIONS CHANGE	
Submitted _____		Design Engineer
Recommended: _____		Asst. Chief Engineer, Pre-Constr.
Approved: _____		Chief Engineer