

224-BZ1

FHWA REGION	STATE	FED. AID PROJ. NO.	UNIT NO.
8	N.D.	M-1-988(02)000	21

- INSTALL CURB & GUTTER, TYPE - I
15+00 TO 20+00 Lt. 500.0 L.F.
15+00 TO 20+00 Rt. 500.0 L.F.
- INSTALL REIN. CONC. PIPE SEWER
15+00 TO 17+32 27" x 27" R.C.P.S. C.I.III
17+22-85.3' Lt. TO 17+34 30" x 76" R.C.P.S. C.I.IV-IRCES.
17+34 TO 17+42.6-60.4' Lt. 30" x 60" R.C.P.S. C.I.IV-IRCES.
17+43.5 TO 17+49 Lt. 30" x 32" R.C.P.S. C.I.IV-IRCES.
- INSTALL 60" MANHOLE
17+34 1 Ea.
- INSTALL MANHOLE RISER
17+34 60" x 18.99'
17+43-64.4' Rt. 60" x 15.16'
- ADJUST MANHOLE
15+32-22' Rt. 1 Ea.
- INSTALL FOUNDATION FILL
17+34 & 267 C.Y.
- INSTALL 30" SLUICE GATE MANHOLE
17+43-64.4' Rt. 1 Ea.

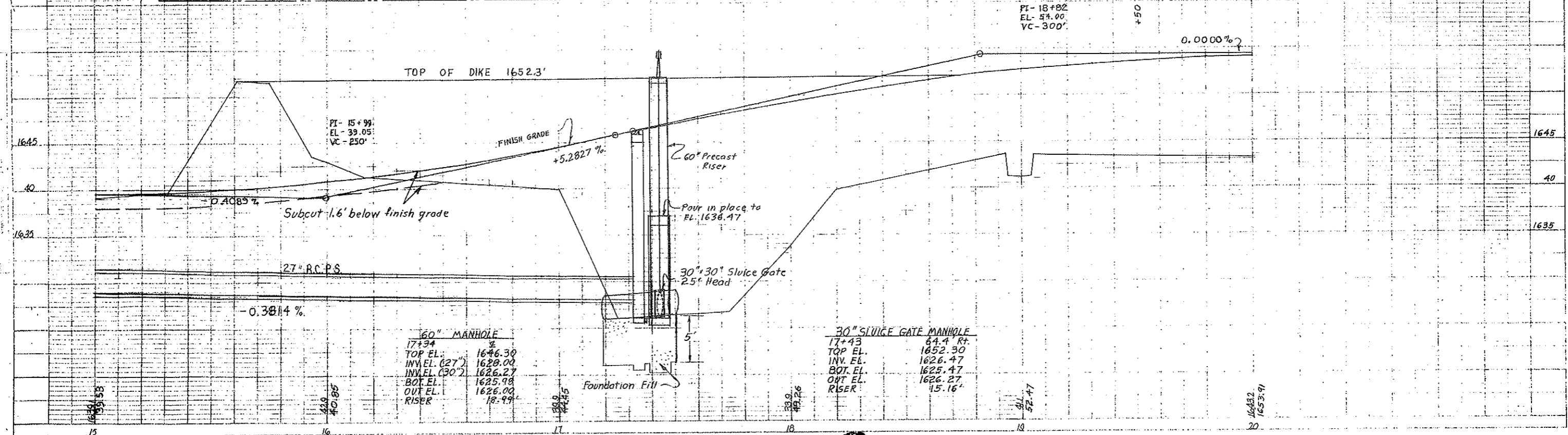
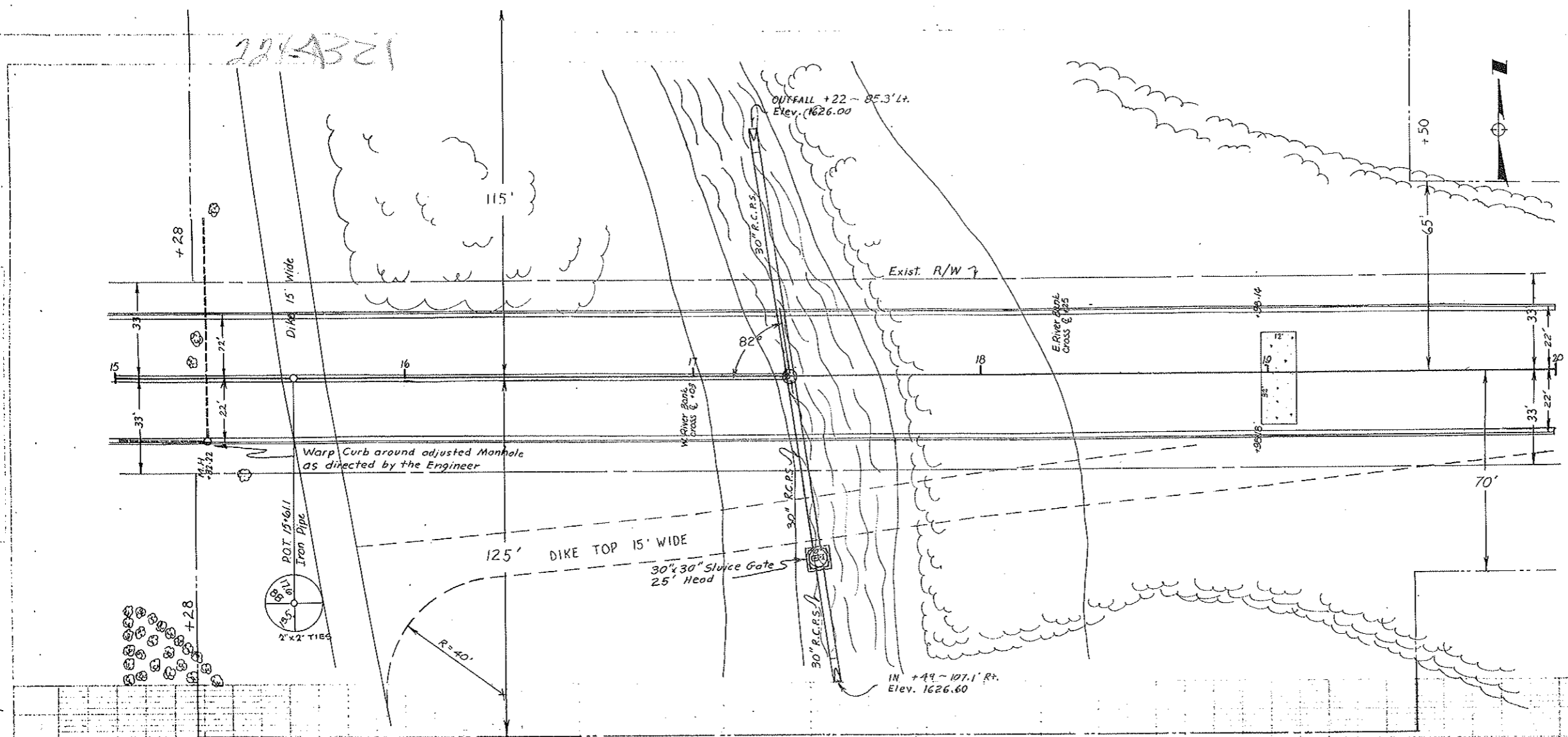

FHWA REGION	STATE	PROJ. AND PROJ. NO.	SHEET NO.
8	N.D.	M-1-988(C02)000	22

INSTALL CONC. DRIVEWAY
24+50 To 24+80 - 75' Lt 50 S.Y.

Note: Tie end of berm into the river bank.

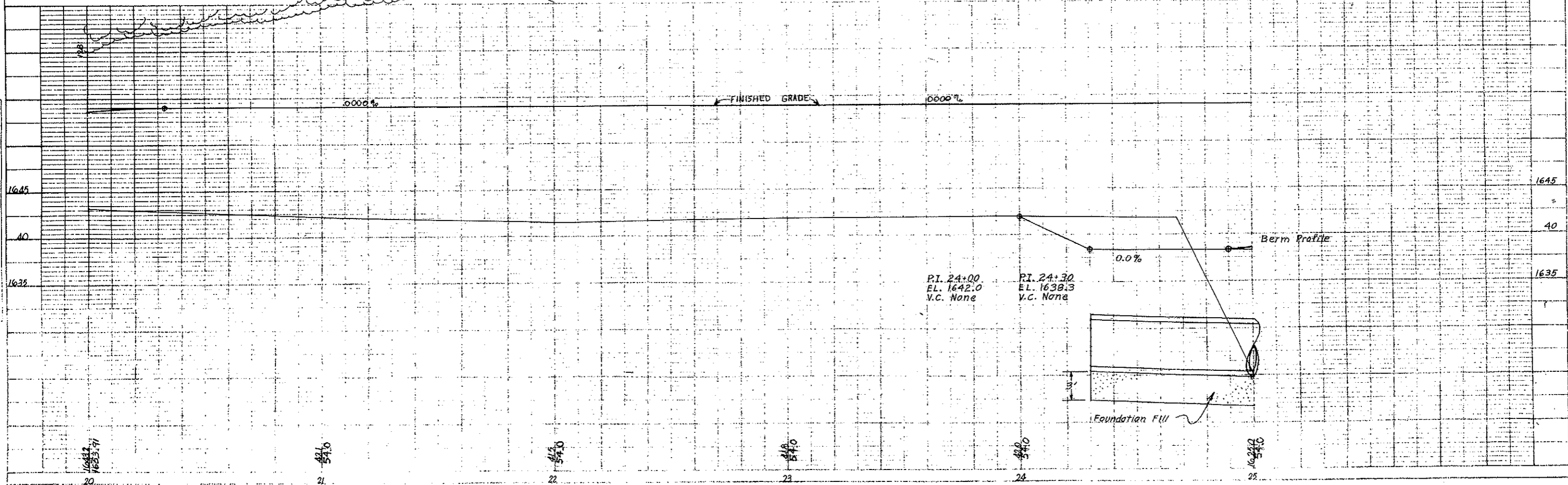
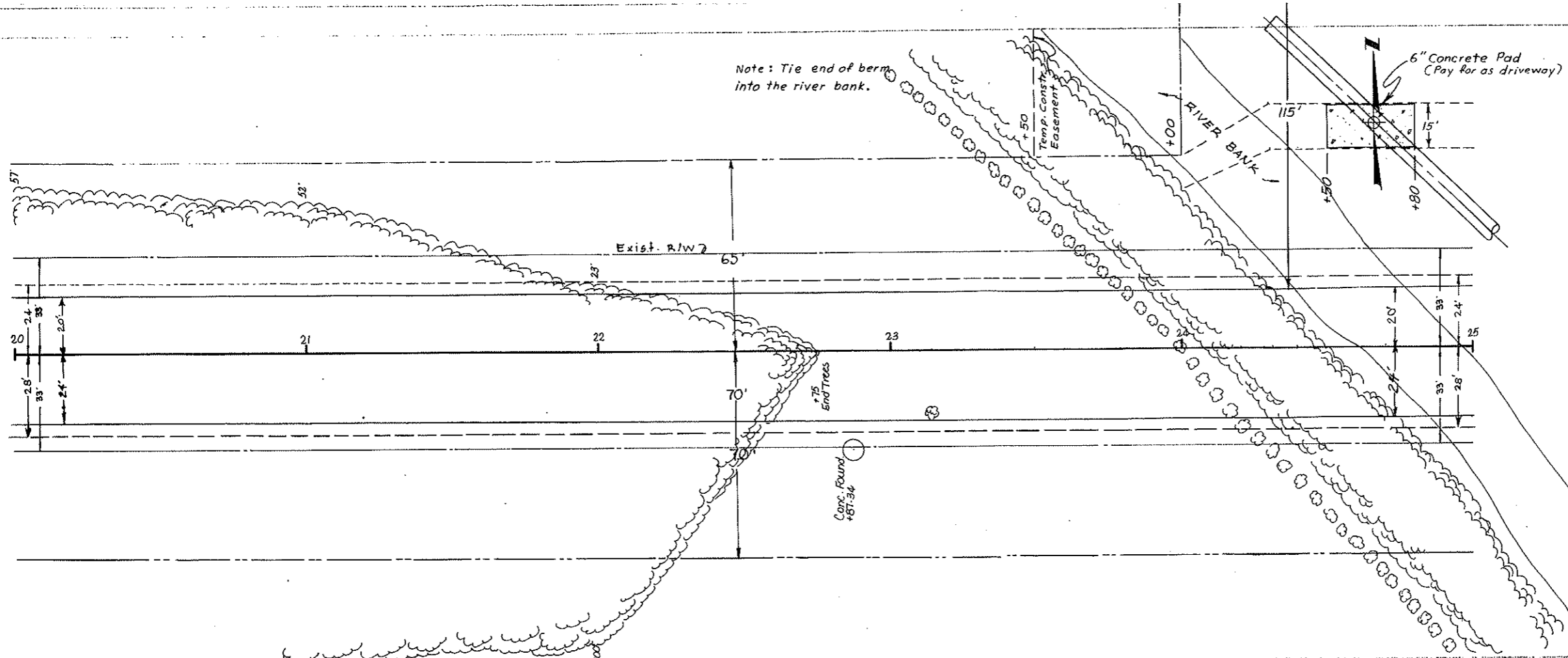

NOTE: BOOK ALIGNMENT CHECKED BY ME (WAY CREATED)

NOTE: BOOK PLATTED AND CHECKED BY ME (STRUCTURE INFORMATION FILE)