

- CONSTRUCTION NOTES**
- UTILITY LOCATIONS SHOWN ON THE PLANS ARE APPROXIMATE. THE CONTRACTOR SHALL BE RESPONSIBLE FOR LOCATING ALL UTILITIES PRIOR TO ANY CONSTRUCTION ACTIVITY. THE NORTH DAKOTA "ONE-CALL" NUMBER IS 1-800-795-0555.
 - APPROXIMATE TOP OF ROAD SUBGRADE SHALL BE BY OTHERS, PRIOR TO CONSTRUCTION. CONTRACTOR WILL HAVE TO SHAPE SUBGRADE AS REQUIRED TO CONSTRUCT ROADWAYS.
 - CONTRACTOR SHALL PROTECT ALL SURVEY MONUMENTS. MONUMENTS SHALL BE LOCATED AND MARKED BY THE OWNER'S REPRESENTATIVE. MONUMENTS DISTURBED OR DESTROYED SHALL BE REPLACED BY THE OWNER'S REPRESENTATIVE AT THE CONTRACTOR'S EXPENSE.
 - THE CONTRACTOR SHALL REMOVE AND DISPOSE OF ALL ASPHALT PAVEMENT AND CURB & GUTTER TO A LEGAL OFF SITE LOCATION AS REQUIRED TO MAKE TIE-INS TO THE EXISTING STREETS.
 - THE CITY OF WANDAN WILL HIRE AN INDEPENDENT TESTING LABORATORY TO COMPLETE ALL REQUIRED TESTING, SCHEDULING AND COORDINATION OF ALL TESTING WILL BE THE CONTRACTOR'S RESPONSIBILITY.

| Station | Station | Station | Station |
|--|---|---|---|
| Sta 8+37.26 N 413497.48 E 1874331.97 | Sta 10+00.00 N 413289.07 E 1874335.78 | Sta 12+50.00 N 412438.52 E 1874455.51 | Sta 15+00.00 N 412438.52 E 1874455.51 |

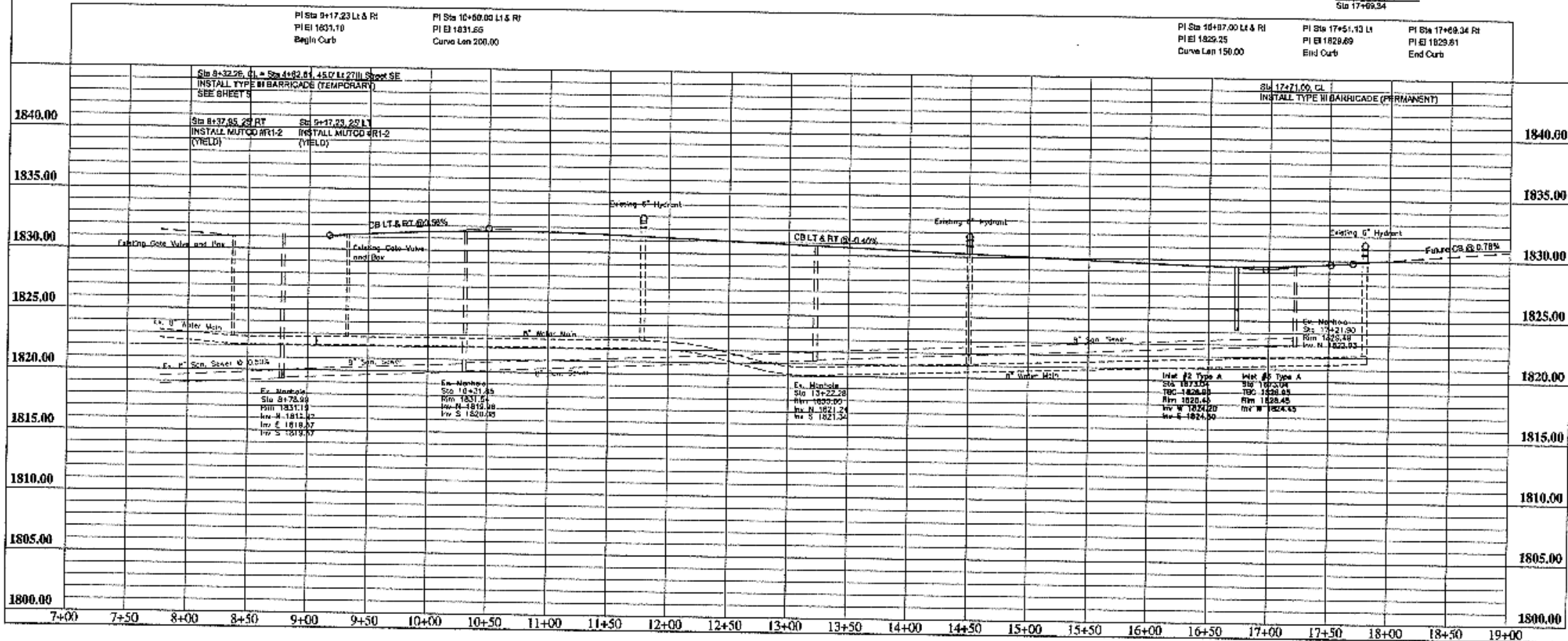
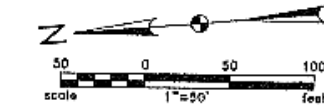

APPROXIMATE QUANTITIES

| Paving Items | Quantity |
|------------------------------------|----------|
| Watering | 18 Mgal |
| Subgrade Preparation | 4166 SY |
| AC Stabilized Base | 491 Ton |
| Asphalt Cement - Base (PG58-28) | 31 Ton |
| AC Surfacing Course | 393 Ton |
| Asphalt Cement - Surface (PG58-28) | 25 Ton |
| Bituminous Tack Coat | 177 Gal |
| Bituminous Seal Coat | 1202 Gal |
| Cover Aggregate | 49 Ton |
| Blotter Sand | 2 Ton |
| Curb and Gutter (Unreinforced) | 1748 LF |
| Adjust Manhole Coaling | 3 EA |
| Type III Barricade (Permanent) | 1 EA |
| MUTCD #R1-2 | 2 EA |

RECORD DRAWING

| | | |
|---|-----------------------------------|-------------------------------------|
| PLAINVIEW HEIGHTS TENTH ADDITION STREET IMPROVEMENT DISTRICT NO. 2006-01 WANDAN, NORTH DAKOTA | | SHEET NO. 7 |
| Kadmas Lee & Jackson Engineers Planners | | PLAINVIEW DRIVE PLAN AND PROFILE |
| DATE: 05/05/08 DRAWN BY: [Name] CHECKED BY: [Name] | SCALE: AS SHOWN DATE: 05/05/08 | PROJECT NO.: 2006-01 |