

- CONSTRUCTION NOTES**
- CONTRACTOR SHALL USE EXCESS EXCAVATION MATERIALS ONSITE TO BACKFILL EXPOSED STORM SEWER IN FORMER DETENTION POND AREA. SEE DETAIL SHEET 2.
 - CONTRACTOR SHALL USE CARE AS NOT TO DISTURB EXISTING SANITARY SEWER BEDDING/EMBANKMENT BETWEEN STA 3+91.01 TO STA 4+27.01. SHOULD THE BEDDING/EMBANKMENT BE DISTURBED, IN THE ENGINEER'S JUDGEMENT, THE CONTRACTOR WILL BE RESPONSIBLE FOR RECOMPACTING THE SANITARY TRENCH PRIOR TO PLACING THE STORM SEWER BETWEEN THESE STATIONS. THE CONTRACTOR SHALL USE CARE WHEN COMPACTING STORM SEWER BEDDING OVER THE SANITARY LINE.

Inlet Number	2	3
Top of Curb	1828.85	1828.85
Top P.C. Section	1827.95	1827.95
Invert Elev. N	-	-
Invert Elev. E	1824.30	-
Invert Elev. S	-	-
Invert Elev. W	1824.20	1824.45
Length P.C. Section	3.75'	3.50'

BOP 0+00.00
 N 412832.47
 E 1873851.88

BW&N Easement
 8th Ave 85 Sta 25+31.38, 40.00' R+
 Storm Easement Sta 0+00.00, CL

EOP 5+64.81
 N 412713.35
 E 1874466.65

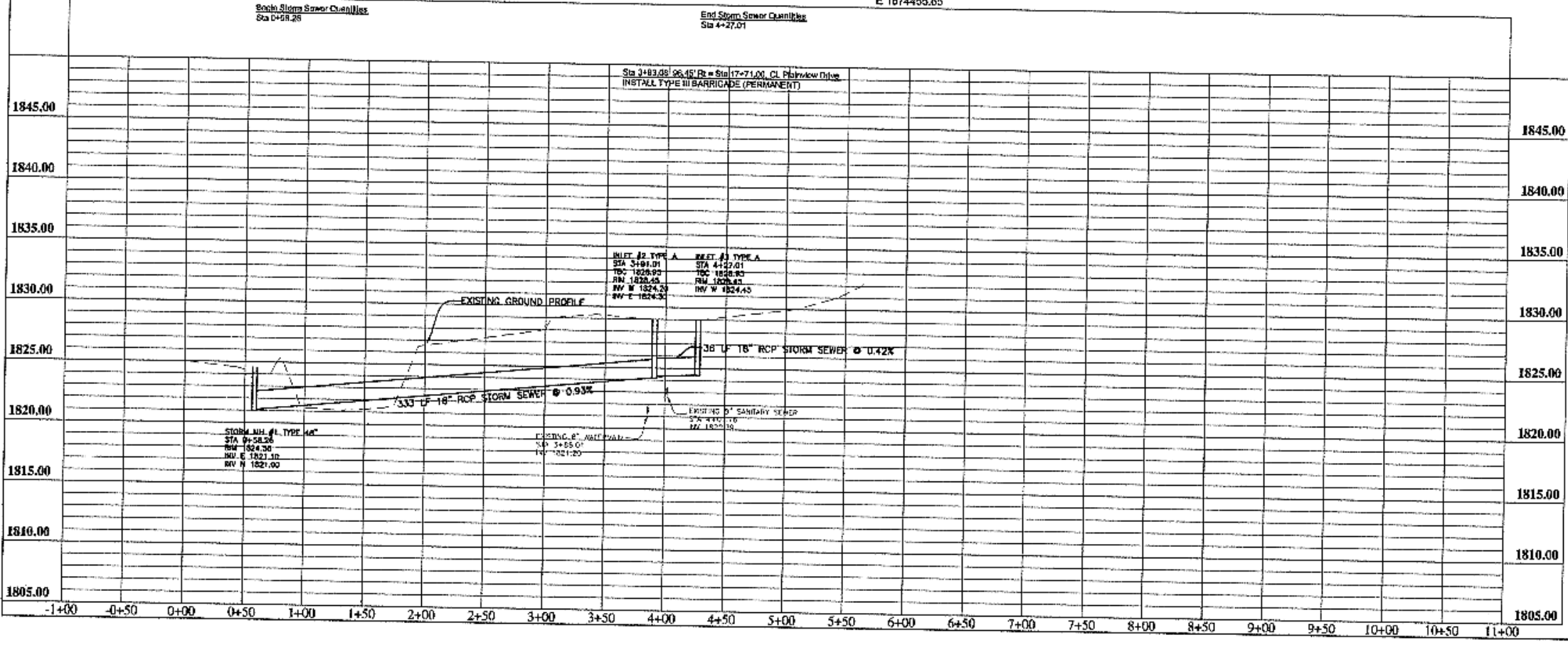
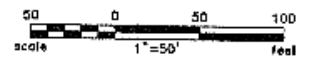

APPROXIMATE QUANTITIES

Storm Sewer Items	Quantity
Plyrun Gravel	87 Ton
Subcut Gravel	8 Ton
18" RCP Sewer	367 LF
Type A 36" Inlet	2 EA

RECORD DRAWING

Rev'd	PLAINVIEW HEIGHTS TENTH ADDITION STREET IMPROVEMENT DISTRICT 2008-01 HARRIS, NORTH CAROLINA	SHEET NO.	8
Kadmas Lee & Jackson	ENGINEERS ARCHITECTS	STATION	14018141
DATE	10/20/08	SCALE	3/4"=1'-0"
PROJECT	STORMWATER EASEMENT PLAN AND PROFILE	DATE	10/20/08
DESIGNED BY	JK	CHECKED BY	JK
DRAWN BY	JK	DATE	10/20/08
SCALE	1/4"=1'-0"	DATE	10/20/08
PROJECT	STORMWATER EASEMENT PLAN AND PROFILE	DATE	10/20/08
SCALE	1/4"=1'-0"	DATE	10/20/08