

NICOLA'S 4TH SANITARY SEWER ALONG HIGHWAY 1806

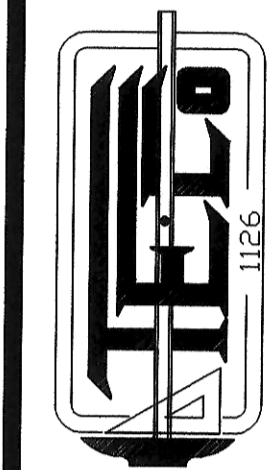

TOMAN ENGINEERING COMPANY
CONSULTING CIVIL & ENVIRONMENTAL ENGINEERS
908 2ND ST. N.W. • MINNAPOLIS, NORTH DAKOTA 58505 • 701-653-6483

TOMAN ENGINEERING COMPANY
CONSULTING CIVIL & ENVIRONMENTAL ENGINEERS
908 2ND ST. N.W. • MINNAPOLIS, NORTH DAKOTA 58505 • 701-653-6483



PROJECT:
SANITARY SEWER
DISTRICT NO. 40 - AREA "A"
CITY PROJECT NO. 96-9

NO.	AS-BUILT'S	REVISIONS	BY	DATE	REASON
1			AR	2/99	ISSUE FOR CONSTRUCTION

TITLE: NICOLA'S 4TH SEWER ALONG HIGHWAY 1806
SHEET NUMBER
3
OF 11 SHEETS

LEGEND

- PAVED ROAD
- UNPAVED ROAD
- BRIDGE
- CULVERT
- BUILDING
- FORCE MAIN
- SEWER
- TRIPLE EDGE
- SINGLE TREE
- INDEX CONTOUR
- INTERMEDIATE CONTOUR
- DEPRESSED BODY CONTOUR
- DEPRESSED INTERMEDIATE CONTOUR
- UTILITY POLE
- LIGHT POLE
- MANHOLE, CATCH BASIN
- SOIL FLAPJACK
- BOUNDARY
- RIVERSHANK
- POWER
- WATER MAIN
- STORM SEWER
- SANITARY SEWER
- HOV ROAD

SCALE: 1"=100'
0 25 50 100 200
JANUARY 1997

CAUTION
LOCATE ALL BURIED UTILITIES BEFORE DIGGING
OVERHEAD POWER

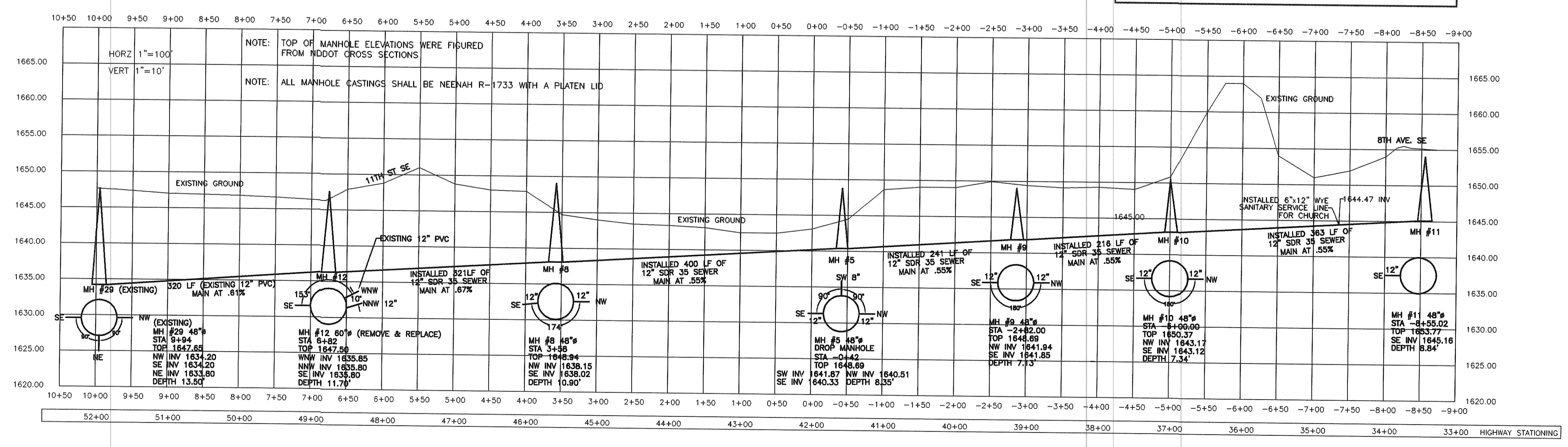
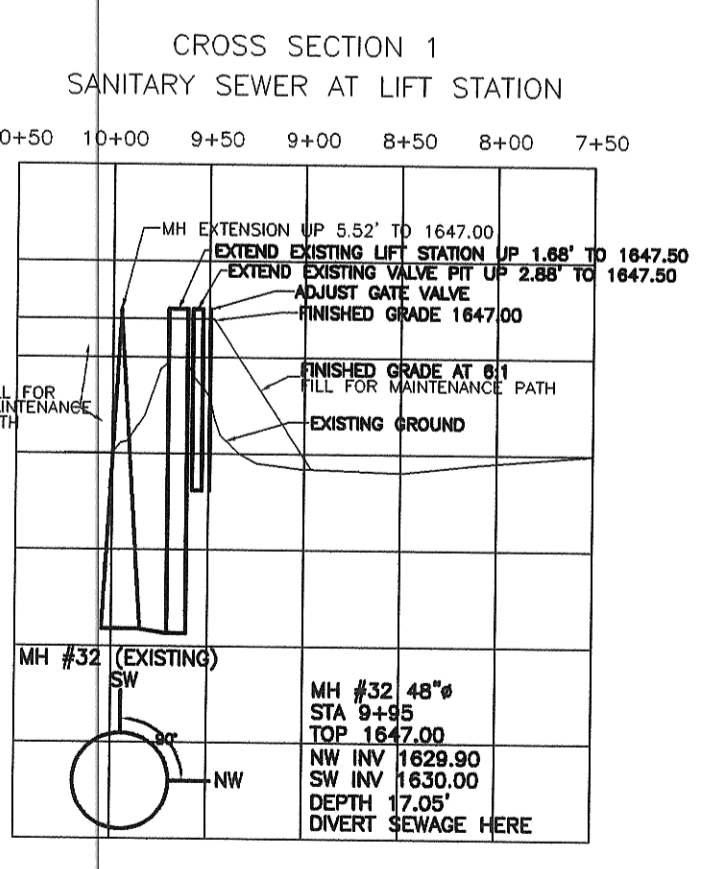
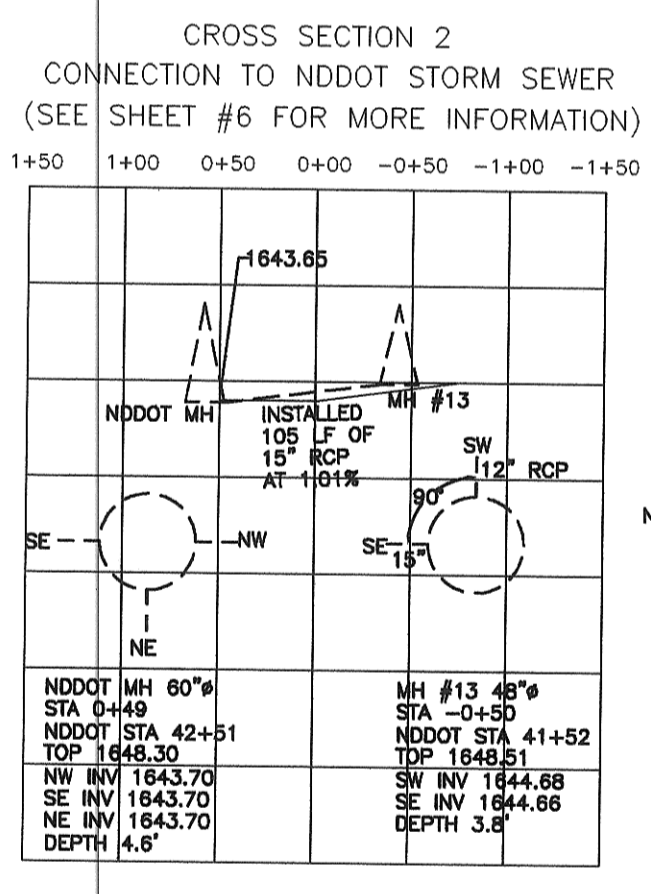
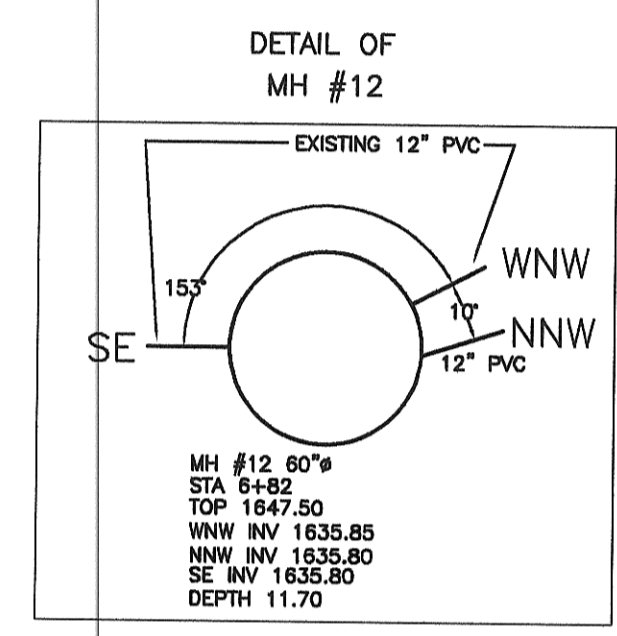

DRAWN: zshw/ahg PLOT DATE: 02/10/99 PLOT TIME: 10:07:38 TDMAN J5