

- NOTES:
- CONTRACTOR SHALL REPAIR ANY EXISTING WATER, SEWER, GAS, POWER, CABLE T.V., STREET LIGHT WIRING, TELEPHONE, OR OTHER UTILITY THAT IS DISTURBED DURING CONSTRUCTION TO THE SATISFACTION OF THE OWNER.
 - UTILITY LOCATIONS ARE NOT GUARANTEED DUE TO LACK OF RECORDS.
 - ALL DISTURBED LAWNS ARE TO BE RESODDED. (40¢ S.Y.) 66I.S.Y.
 - REMOVE EXISTING MANHOLE & SALVAGE CASTING AT THE FOLLOWING LOCATIONS. COSTS ARE TO BE INCIDENTAL TO PROJECT. 12+41 AND 14+21.
 - REMOVE & REPLACE ASPHALT PAVEMENT STA. 10+53 TO 10+87 179'x34'=676 S.F.
 - REMOVE & REPLACE SIDEWALK STA. 10+51 TO 10+89 6" 7766'x2.5'=1942 S.F.
 - REMOVE & REPLACE DRIVEWAY STA. 10+90 TO 11+12 (225 S.F.) REMOVE & REPLACE 4" CONCRETE 12+04 (179.7 S.F.) FOR STORM SEWER CONTROL STRUCTURE
 - INSTALL 450' L.F. 24" PVC. TYPE "A" MH - 2 EA. TYPE "D" MH - 3 EA. (PAY QUANTITY IEA)
 - SEEDING 10-5 A.C. 0.5
 - STA. 12+41-MH. # 11, INCLUDE 10' - 4" PVC PIPE TO CONNECT TO NEW MANHOLE AT ELEVATION SHOWN. INCLUDE COSTS IN MH. # 12.
 - 6" WATERMAIN LOWERING STA. 11+82
 - REMOVE EX. 24" V.C.P. STA. 10+00 TO STA. 14+48 MH. # 12 FILLED W/ K CRETE
 - ALL MOBILE HOMES & SHEDS WITHIN THE CONSTRUCTION AREA SHALL BE REMOVED BY OTHERS.

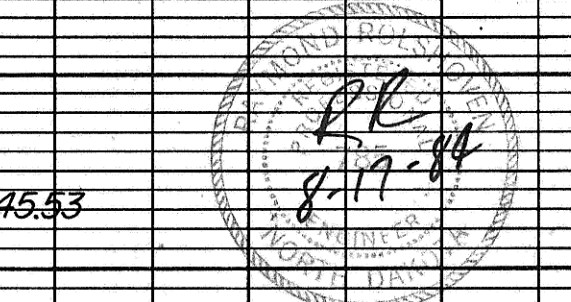
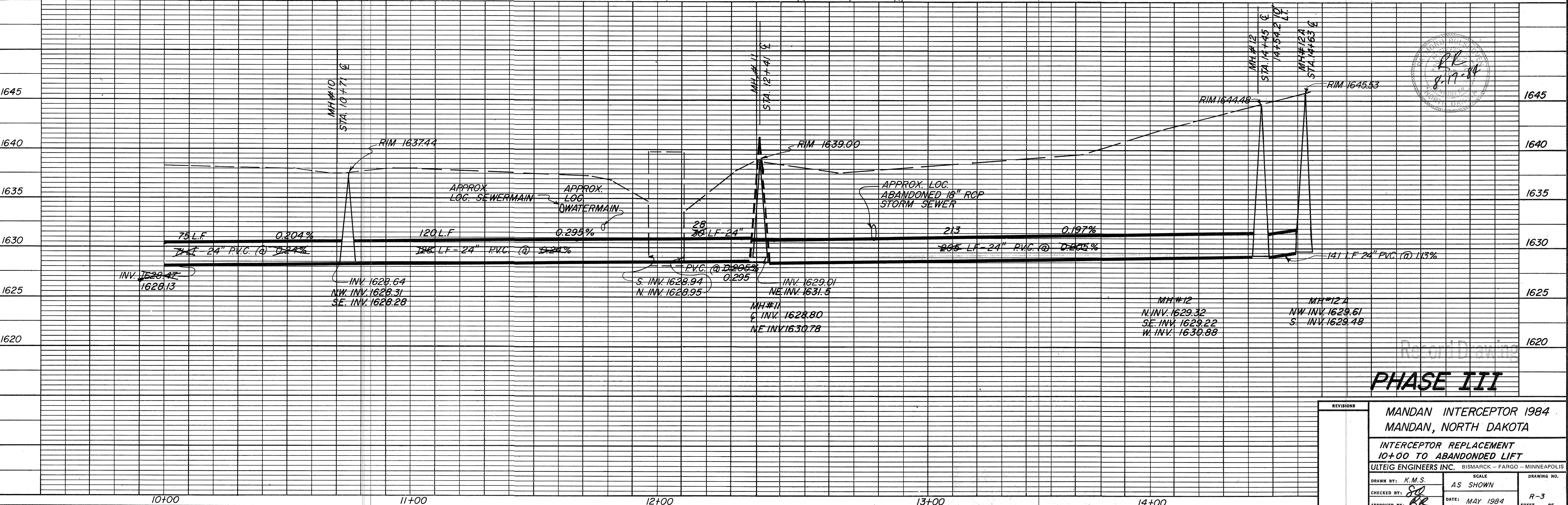

PHASE III

MANDAN INTERCEPTOR 1984
MANDAN, NORTH DAKOTA

INTERCEPTOR REPLACEMENT
10+00 TO ABANDONED LIFT

ULTEIG ENGINEERS INC. BISMARCK - FARGO - MINNEAPOLIS

SCALE: AS SHOWN
DATE: MAY 1984
SHEET: R-3 OF